

## **e-STUDIO3508LP/4508LP**

- > The world's first black and white multifunction system with erasable print function
- > Thanks to the unique Hybrid printing technology, one single device can output black and white as well as reusable prints, which saves paper
- > Equipped with state-of-the-art features for modern document workflows
- > Designed for businesses that want to combine ecology, economy and efficiency



# CONNECT, INTEGRATE, SIMPLIFY AND REUSE

Toshiba's hybrid technology combines conventional printing with erasable printing allowing you to reuse paper over and over again. One single device easily connects, integrates, and simplifies your workflow — and also helps to save valuable resources.

At Toshiba, we are dedicated to serving our customers and committed to the future of the planet with the promise of Together Information.

Black and white printing has never been this green.

The world's first black and white MFP with erasable print function.



# OUR BEST TECHNOLOGY TO ENHANCE YOUR BUSINESS

Optimizing workflow to get the most out of available resources has become essential for businesses that want to be successful. We have designed our Hybrid MFP to offer you all of the features you need to be productive and efficient. But there's more: we have added a unique erasable print function, that can be selected in the print driver just like any other setting.

## Connect

Having access to your documents when you need them is getting more and more important. We have made sure you get what you want, whenever you want and wherever you want.

- > **Multi-Station Print** allows you to send print jobs from your computer and retrieve them at any convenient MFP by authenticating at that device, e.g., by swiping your badge.
- > **Cloud Printing** ensures you have access to your documents no matter where you are. Our embedded apps let you send your documents directly to or print them from Microsoft OneDrive, Google Drive, Dropbox and others.
- > **Mobile Printing** gives you the flexibility to print directly from your mobile device via AirPrint, Google Cloud Print, Mopria Print Service or our Toshiba e-BRIDGE Print & Capture app. With an optional module which activates the WiFi feature, you can easily connect mobile devices directly with the MFP.

## Integrate

Toshiba's Eco Hybrid MFP incorporates the latest e-BRIDGE technology. This makes it easy to integrate the system into your existing IT infrastructure and helps administrators work more efficiently. The open platform architecture also enables the creation of customized workflows to simplify complex scanning, archiving or other document management tasks.

## Simplify

We strongly believe that good technology must be easy to use, and that's how we designed the Hybrid MFP. The large tablet-like screen with an embedded web browser is easy to use and customizable to meet your needs, regardless of the industry you're in. It gives direct access to all functions of the MFP to increase user efficiency.

## Reuse

Toshiba's Eco Hybrid MFP comes with a unique feature: paper can be reused thanks to the erasable blue toner, which has a positive impact on the environment. The erasing can be done either via the Hybrid MFP itself or the optional paper reusing device, the e-STUDIO<sub>RD</sub>301.



# PRINTING HAS NEVER BEEN THIS GREEN

## How it works?

Very often we print documents, which are only needed temporarily, e.g., to proof-read a document or as a reminder to do something. For these cases, Toshiba's Hybrid system gives you the possibility to select the erasable blue toner, so that when you don't need your document anymore, you don't have to throw the paper away, but can erase whatever was printed on it and reuse the sheet. To make it easier rule-based printing can be activated in the print driver. This allows you to define multiple rules for the print driver to then automatically select the blue toner for all e-mails as these type of documents usually tend to be used only temporarily. For more permanent documents, select black and white.

To easily track how much you have already saved, the e-BRIDGE Paper Reuse Report calculates your paper reduction, the average usage of a sheet of paper, and CO2 reduction, all in an easy to view dashboard format.

## How can the toner be erased?

Toshiba's Eco Hybrid MFP itself is capable of erasing the toner. Simply place the used paper into the designated paper cassette and start the process. The blue toner will be erased and you can then place the erased sheets back into the cassette of the MFP to print on them again.

Alternatively, you can use the optional e-STUDIO<sub>RD</sub>301 — an erasing unit with advanced features. Not only does it erase at a speed of up to 30 PPM, it also sorts the paper into reusable and non-reusable paper. Additionally, it can also digitize the documents for electronic archiving before erasing the toner.

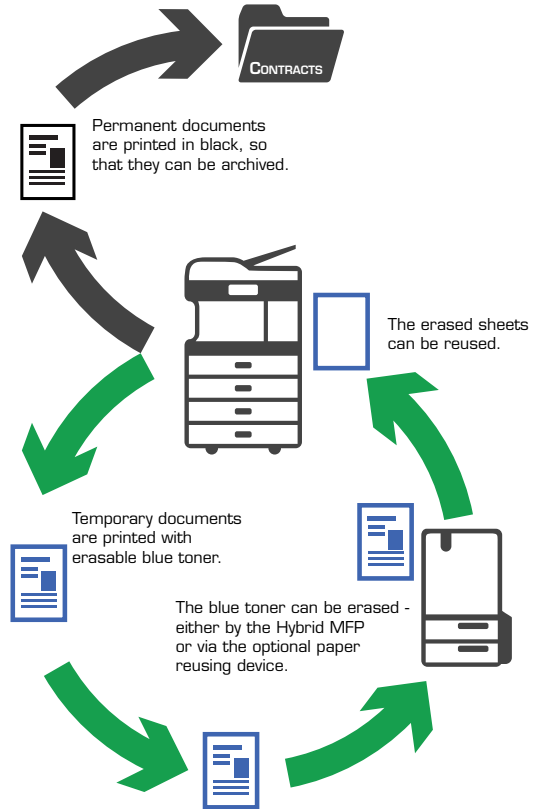

## What is the benefit?

Assuming that you use a sheet of paper five times and you print 4,000 erasable pages per month, you can save 80% of your paper. This means that after five years you will have saved almost 200,000 sheets of paper. In other words: The same amount of paper which you would usually use in one year, will now last five years.

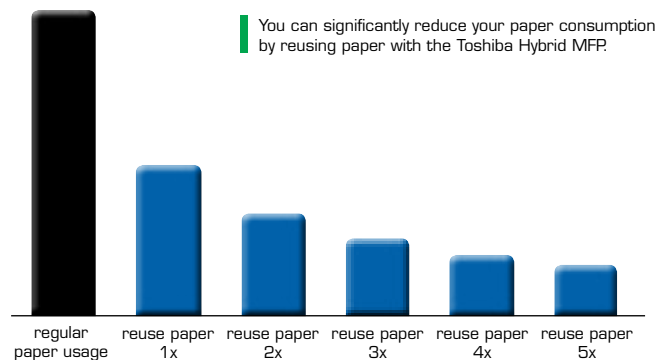

Besides saving costs for paper (purchasing, storage and disposal) there is also a significant environmental benefit as you automatically reduce the carbon emission and water consumption, which is generated during the paper production.

# EVERYTHING YOU NEED IN ONE SYSTEM

## Ecology

The idea of a paperless office has been around for more than 40 years, yet today's business workflows still require a fair amount of documents to be printed. Toshiba now has a great solution for companies that want to be ecologically conscious and still be efficient and economical. Our unique Hybrid printing technology offers everything you would expect from a state-of-the-art multifunction printer (MFP) and more: You can now even reuse the paper.

## Economy

One single system can print in black and white as well as in erasable blue. For you, this means you can use the Hybrid MFP just like any other monochrome device to print in black. You can choose from a variety of paper feed and finishing options to cover all of your needs. Our erasable blue toner allows you to reuse the paper you have printed on, so that you can use less paper, without having to print less. Reducing paper usage will save natural resources, reducing your company's footprint and also helping you save money.

## Efficiency

Driven by Toshiba's e-BRIDGE Next controller, the system will boost your productivity. It provides ease-of-use and ensures that the device is capable of adapting to your document workflow. Whether you need to connect to 3rd party solutions or simply want to optimize your internal processes, the Toshiba Hybrid MFP is there to help you enhance your overall efficiency.



## KEY FEATURES

- > A unique monochrome system with a speed of 35/45 pages per minute (PPM) and 35 PPM in erasable blue ensures the Hybrid MFP can handle even large jobs effortlessly.
- > A customizable, tablet-like user interface, gives easy access to the print, scan, copy, fax and erase functions.
- > Outstanding image quality you can rely on. No matter whether you use black or erasable blue toner, the result will always be the same: impeccable documents.
- > The optional Dual Scan Document Feeder can hold up to 300 sheets while processing documents at an amazing speed of up to 240 images per minute (IPM).
- > A 320GB FIPS 140-2 Validated Self-Encrypting Drive (SED) with Automatic Drive Invalidation (ADI) & Data Overwrite capability provides top level security. IPsec is available to securely encrypt data sent to and from the MFP.

## Main Specifications

<b>Copy System</b>	Indirect Electrostatic Photographic Method/OPC/Laser Printing/Heat Roller Fusing
<b>Display</b>	9" Colour WVGA Touch Screen Tilting Display
<b>Copy Speed</b>	35/45 PPM (LT)
<b>Erasable Blue Speed</b>	35 PPM
<b>Erase Speed</b>	8.5 PPM
<b>First Copy Out</b>	Less than 5.9/4.4 Sec.
<b>First Copy Out</b>	Less than 7.8 Sec. (Erasable Blue)
<b>Warm-Up Time</b>	Approx. 20 Seconds
<b>Copy Resolution</b>	2,400 x 1,200 dpi with Smoothing
<b>Stack Feed Bypass</b>	3.9" x 5.8" to LD, Envelope
<b>Multiple Copying</b>	Up to 999 Copies
<b>Paper Capacity</b>	Standard 1,200 Sheets/Max. 3,200 Sheets
<b>Original Feed</b>	Optional 300-Sheet DSDf or 100-Sheet RADF
<b>Scan Speed &amp; Weights</b>	DSDf Scan: Up to 240 IPM Duplex, 120 IPM Simplex (Monochrome or Colour), Simplex: 9.3-110 lb Bond, Duplex: 9.3-110 lb Bond RADF Scan: Up to 73 IPM (Monochrome or Colour); Simplex: 9.3-41.8 lb Bond, Duplex: 13.3-41.8 lb Bond
<b>Max. Original Size</b>	LD
<b>Paper Feed Sizes</b>	Drawer 1: 550 Sheets-ST-R to LD Drawer 2: 550 Sheets-ST-R to LD Stack Feed Bypass: 100 Sheets-3.9" x 5.8" to LD Opt. 550-Sheet Paper Feed Pedestal-ST-R to LD Opt. 550-Sheet Drawer for PFP-ST-R to LD Opt. Envelope Cassette for PFP-Approx. 60 Envelopes/550 Sheets-ST-R to LG Opt. 2,000-Sheet Tandem LCF (Pedestal Type)-LT Only
<b>Paper Weights</b>	Standard: 550 Sheets x 2-16 lb Bond-140 lb Index Stack Feed Bypass: 100 Sheets-14 lb Bond-140 lb Index Opt. 550-Sheet Paper Feed Pedestal-16 lb Bond-140 lb Index Opt. 550-Sheet Drawer for PFP -16 lb Bond-140 lb Index Opt. Envelope Cassette for PFP-16 lb Bond-140 lb Index Opt. 2,000-Sheet Tandem LCF (Pedestal Type), 17-28 lb Bond Standard Automatic Duplex Unit (16 lb Bond-140 lb Index)
<b>Duplex</b>	Standard
<b>Reproduction Ratio</b>	25% to 400%
<b>Max Duty Cycle</b>	210K Month
<b>Weight</b>	Approx. 128 lb
<b>Approx. Dimensions</b>	23" (W) x 23" (D) x 31" (H)
<b>Toner Yield</b>	38.4K (Black) 21.5K (Erasable Blue)
<b>Power Source</b>	120 Volts, 50/60 Hz, 15 Amps
<b>Power Consumption</b>	Maximum 1.5kW (120V)
<b>CPU</b>	Intel Atom™ 1.33GHz (Dual-Core)
<b>Memory</b>	4GB
<b>Hard Disk Drive</b>	320GB Self-Encrypting Drive FIPS 140-2 Validated

## e-BRIDGE Next Print Specifications

<b>PDL</b>	PCL5e, PCL5c, PCL6 (PCL XL), PS3, PDF, XPS, JPEG
<b>Black Print Speed</b>	35/45 Pages Per Minute (LT)
<b>Erasable Blue Speed</b>	35 PPM
<b>Print Resolution</b>	600 x 600 dpi (1 bit) or 2,400 x 600 dpi (with Smoothing), 1,200 x 1,200 dpi (2 bit) or 3,600 x 1,200 dpi (with Smoothing) PS3 Only
<b>Operating Systems</b>	Windows® Vista, Windows Server® 2008/R2, Windows® 7, 8, 8.1, 10, Windows Server® 2012/R2, Macintosh® (Mac OS x 10.4, 10.5, 10.6, 10.7, 10.8, 10.9, 10.10, 10.11), Unix®, Linux®
<b>Network Protocols</b>	TCP/IP (IPv4, IPv6), NetBIOS over TCP/IP, IPX/SPX® for Novell® Environments, EtherTalk® for Macintosh Environments
<b>Printing Protocols</b>	SMB, LPR/LPD, IPP (Ver.1.1) w/Authentication, AppleTalk PAP or EtherTalkTM, Port 9100 (bi-directional), NetWare P-SERVER LPD w/ iPrint, WS Print, FTP
<b>Print Drivers</b>	Windows® Vista SP2 (32-bit, 64-bit), Windows Server® 2008 SP2 (32-bit, 64-bit), Windows Server® 2008 R2 SP1 (64-bit), Windows® 7 SP1 (32-bit, 64-bit), Windows® 8/8.1 (32-bit, 64-bit), Windows Server® 2012/R2 (64-bit), Windows® 10 (32-bit, 64-bit), Mac OS® X 10.6.8, 10.7.4, 10.8, 10.9, 10.10 RJ-45 Ethernet (10/100/1000 Base-T), USB 2.0 (High-speed), Optional 802.11b/g/n, Wireless LAN, Optional Bluetooth
<b>Interface</b>	
<b>Wireless Device</b>	AirPrint®, Mopria®, e-BRIDGE Print & Capture Application on iOS and Android (Available via Apple App Store or Google Play)
<b>Device Management</b>	TopAccess, eFMS 6.2 (e-BRIDGE Fleet Management Software)
<b>Account Control</b>	Up to 10,000 users or 1,000 Departments Supports User Authentication (on Device), Login Name/Password (via Windows domain) or Login Name/Password (via LDAP Server) for Copy, Print, Scan, Fax, List, and User Function
<b>Accessibility Features</b>	Tilt Front Panel, Job Programs, Universal Grip for Paper Trays, Disable Screen



Windows 7 Compatible  
Windows 8 Compatible  
Windows 10 Compatible

Designs and specifications subject to change without notice. For best results and reliable performance, always use supplies manufactured or designated by Toshiba. Not all options and accessories may be available at the time of product launch. Please contact a local Authorized Toshiba Dealership or Toshiba Business Solutions Branch for availability. Toner yields are estimates based on 5% coverage, letter-size page. Driver and connectivity feature support varies by client/network operating system. Product names may be trademarks of their respective companies. This is a Class 1 laser product complying with IEC60825-1.

Inv. Code CE-ES3508LP-B

<b>Security Features</b>	Timeout and Audible Beep Message Alerts User Authentication, On-Board Data Scramble Function, SCEP, Disable e-Filing, Disable Copy, Disk Overwrite, IP Address Filtering (10 Sets), MAC Address Filtering (10 Sets), Network Service Control, Network Port Control, SMB Packet Signing, SSL (HTTP, IPP, LDAP, SMTP, POP, FTP, DPWS), IPsec (IKEv1, IKEv2), Security Mode Change, CC Certified (ISO/IEC15408 EAL3+)*, IEEE2600.1, IEEE802.1X, Digital Signature for Client Utilities, Password Policy, Password Lock, Password Expiration, Self Testing, Job Access Control, Log Access Control for Job Log, Security Stamp * Compliant with IEEE2600.1 in High security mode.
<b>Environmental Stds.</b>	Energy Star (V2.0), EPEAT Gold, Blue Angel Mark (RAL UZ-171, MFD), Californian Proposition 65, Nordic Swan, RoHS
<b>Certification</b>	WHQL (Windows 7, 8, 8.1, 10, 2008 R2, 2012, 2012 R2), Novell, Citrix, SAP

## Scan Specifications

<b>Scan Speed</b>	DSDf Scan: Up to 240 IPM Duplex, 120 IPM Simplex (Monochrome or Colour) RADF Scan: Up to 73 IPM (Monochrome or Colour)
<b>Scan Modes</b>	Standard: Full Colour, Auto Colour, Monochrome, Grayscale
<b>Scan Resolution</b>	600 dpi, 400 dpi, 300 dpi, 200 dpi, 150 dpi, 100 dpi
<b>File Formats</b>	Monochrome: TIFF-Multi/Single Page, PDF-Multi/Single Page, Searchable PDF (Opt.), XPS-Multi/Single Page, DOCX (Opt.), XLSX (Opt.), PPTX (Opt.) Colour/Grayscale: JPEG, TIFF-Multi/Single Page, PDF-Multi/Single Page, Slim PDF, Searchable PDF (Opt.), XPS-Multi/Single Page, DOCX (Opt.), XLSX (Opt.), PPTX (Opt.)
<b>Image Compression</b>	Colour/Grayscale: JPEG (High, Middle, Low)

## Facsimile Specifications

<b>Compatibility</b>	Super G3
<b>Data Compression</b>	MH/MR/MMR/JBIG
<b>Transmission Speed</b>	Approx. 3 Seconds per Page
<b>Fax Modem Speed</b>	Up to 33.6 Kbps
<b>Memory Transmission</b>	100 Jobs (with HDD), 2,000 Destinations Max. 400 Destinations/Job
<b>Scan Speed</b>	0.7 Seconds per Page, Maximum 73 IPM

## e-Filing Specifications

<b>Operation Method</b>	Colour Touch Screen Control Panel or Client PC
<b>Number of Boxes</b>	1 Public Box, 200 Private User Boxes
<b>Capacity of Boxes</b>	100 Folders Per Box, 400 Documents Per Folder/Box, 200 Pages per Document

## Accessories (Options)

<b>Platen &amp; Document Feeder Options</b>	Meta Scan Enabler	GS-1010	
DSDf	MR-4000	IPsec Enabler	GP-1080
RADF	MR-3031	Unicode Font Enabler	GS-1007
Platen Cover	KA-5005PC	Embedded OCR Enabler	
		Single License	GS-1080
<b>Additional Paper Options</b>		Five Licenses	GS-1085
Paper Feed Pedestal	KD-1058	Multi-Station Print Enabler	
Drawer Module	MY-1048	Single License	GS-1090
Envelope Cassette Option	MY-1049	Five Licenses	GS-1095
Large Capacity Feeder	KD-1059LT	Advanced Scanning (ReRite)	GB-1280
<b>Finishing Options</b>		<b>Miscellaneous Options</b>	
Inner Finisher	MJ-1042	Stand	ST-5005
50-Sheets Staple Finisher	MJ-1109	Accessible Arm	KK-2560
Saddle-Stitch Finisher	MJ-1110	Harness Kit for Coin Controller	GQ-1280
Hole Punch Unit for MJ-1042	MJ-6011N	Dedicated Erase Unit	KH-1021NA
Hole Punch Unit for MJ-1109/MJ-1110	MJ-6105N		
Bridge Kit	KN-5005		
Job Separator	MJ-5015		
<b>Connectivity/Security Options</b>			
FAX Unit/2nd Line for FAX Unit	GD-1370NA		
Wireless LAN/Bluetooth	GN-4020		
Bluetooth Keyboard	GR-9000		
Accessory Tray	GR-1250		
Panel 10-Key Option	GR-1260		
Card Reader Holder	GR-1290		

### Corporate Office

75 Tiverton Court  
Markham, Ontario  
L3R 4M8

Phone  
Fax

905-470-3500  
905-470-3450

Web Site

www.toshiba.ca